

FILE

P25490

DESTINATION

ROTORUA

ROTORUA DISTRICT
COUNCIL

Building Consent No:32241
Section 51, Building Act 2004

Issued:18Nov05



Rotorua District Council
1061 Haupapa Street
Private Bag 3029
Rotorua, New Zealand
P: 07 348 4199
F: 07 346 3143
E: mail@rdc.govt.nz
W: www.rdc.govt.nz

The Building

Street Address of building: 75A POHUTUKAWA DRIVE, OWHATA, ROTORUA 3201
Legal Description of land where building is located:
FLAT 1 DPS 44084
Building Name: INSTALL NEW F/S PELLET FIRE

The Owner

Name of owner: MR ROBERT HENRY LAWLER
Mailing Address: ATTN: KATHRYN CUNNINGHAM
C/O NATURES FLAME
BOX 11259, CHRISTCHURCH

Contact Person: SOLID ENERGY RENEWABLE FUELS
Mailing Address: P O BOX 11259
SOCKBURN
CHRISTCHURCH 8030

Street address/registered office: 75A POHUTUKAWA DRIVE
OWHATA
ROTORUA 3201

Phone number: 021 848791 (Bus.)
3454019 (Pvt.)

Facsimile number:

Email address:

Website:

First point of contact for communications with council/building consent authority:

Building Work

The following building work is authorised by this consent:
Project: Minor Works
Intended Use: INSTALL NEW F/S PELLET FIRE

This building consent is issued under section 51 of the Building Act 2004.
This building consent does not relieve the owner of the building (or proposed building) of any duty or responsibility under any other Act relating to or affecting the building (or proposed building).

This building consent also does not permit the construction, alteration,

demolition, or removal of the building (or proposed building) if that construction, alteration, demolition, or removal would be in breach of any other Act.

This building consent is subject to the following conditions:

(a) the building must be altered, removed, or demolished on or before the end of 5 years from the date of issue of this consent (being the specified intended life of the building); and

1: Notice to be given by owner or agent that building work is ready for inspection shall be given to the Rotorua District Council at least 1 (one) working day in advance of covering in any of the following work:

At the completion of the work authorised by this Building Consent.

Please arrange the booking of inspections and direct enquiries regarding this consent to the Building Services Department, phone (07) 348 4199.

2: Solid Fuel Heaters

At the completion of the heater installation, Building Control Officer is to inspect prior to the ceiling plate being fixed.

Any timber or combustible materials within 25mm of the flue safety liner is to be protected with Micore 160 board or other approved material.

Flue safety liner to extend below the ceiling level with ceiling cut back 25 mm clear of safety liner.

Provide seismic resistance to heater base.

3: Code Compliance Certificate

The owner or agent shall as soon as practicable, advise the Rotorua District Council that all building work has been completed to the extent required by this Building Consent.

SECTION 93(2)(b)(i) BUILDING ACT 2004

The owner or agent must apply for a Code Compliance Certificate within 2 years after the date on which the Building Consent for the building work was granted.

4: Standard Conditions

If the work is not commenced within six months and/or reasonable progress has not been made within twelve months a written extension of time can be granted on application to the Council.

Any deficiency not specifically drawn to the attention of the builder or owner by the Building Officer shall not be deemed to have been approved.

5: Standard Statement

THIS BUILDING CONSENT IS ISSUED SUBJECT TO ALL OTHER OUTSTANDING CONSENTS HAVING BEEN APPROVED. WORK SHALL NOT COMMENCE AND INSPECTIONS WILL NOT BE UNDERTAKEN UNTIL THOSE OUTSTANDING CONSENTS HAVE BEEN COMPLIED WITH.

A CODE COMPLIANCE CERTIFICATE MAY NOT BE ISSUED IF ALL FLASHINGS HAVE NOT BEEN INSPECTED PRIOR TO THE COVERING UP OR CLOSING IN OF BUILDING WORK.

SECTION 52 BUILDING ACT 2004 (LAPSE OF BUILDING CONSENT)

A Building Consent lapses and is of no effect if the building work to which it relates does not commence within 12 months of the date of issue unless prior arrangements are made with the Building Consent Authority

TYPE 1 DOMESTIC SMOKE ALARM SYSTEM - CLAUSE F7 WARNING SYSTEMS:

- * Requires that an appropriate means of detection and warning for fire must be provided within each household unit.
- * Smoke alarms shall be located on the escape routes on all levels within household units.
- * On all levels containing the sleeping spaces, the smoke alarms shall be located either:

- a) in every sleeping space; or
- b) within 3 metres of every sleeping space. In this case, the smoke alarms must be audible to sleeping occupants on the other side of closed doors.

These will be required on all new dwellings and retrospectively fitted in dwellings when, and if, a Building Consent for additions or alterations is applied for.

A CODE OF COMPLIANCE CERTIFICATE WILL NOT BE ISSUED UNTIL THE SMOKE ALARMS HAVE BEEN INSTALLED AND SEEN OPERATING.

Compliance Schedule

A compliance schedule is not required for the building.



Signature

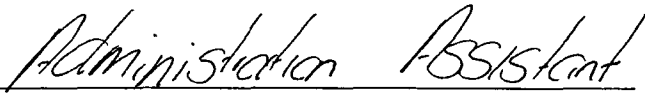

Position

On behalf of: ROTORUA DISTRICT COUNCIL

Date: 18 Nov 2005

CT: SA38A/624
~~SA38A/625~~

P25490
I-136242

ROTORUA DISTRICT COUNCIL
Referred to: Build
Rec'd 17 NOV 2005
Copy to: Chw \$ 165.00
Instructions: To Finance

PIM / APPLICATION No. 38941
DATE RECEIVED 17-11-05
DATE ISSUED _____
SITE FILE No. P25490

Form 2

APPLICATION FOR PROJECT INFORMATION MEMORANDUM AND/OR BUILDING CONSENT

Section 33 or section 45, Building Act 2004

THE BUILDING

Street address of building:

[for structures that do not have a street address, state the nearest street intersection and the distance and direction from that intersection]

75a Pohutukawa Drive
Owhata
Rotorua 3201

Legal description of land where building is located:

[state legal description as at the date of application and, if the land is proposed to be subdivided, include details of relevant lot numbers and subdivision consent]

Subdivision Consent (if applicable) _____

Valuation No. 06993/163-01A Lot No. 163-01A

DPS 44084 Section _____

Block _____ Survey District _____

Building name: _____

Location of building within site/block number:

[include nearest street access]

Number of levels: 1

[include ground level and any levels belowground]

Level/unit number: _____

[insert level/unit number if applicable]

Area: _____ m²

[total floor area; indicate area affected by the building work if less than the total area]

Current, lawfully established, use:

[include number of occupants per level and per use if more than 1]

Year first constructed: _____

[insert year, approximate date is acceptable e.g. c1920s or 1960-1970]

Expected completion date: _____

[insert month year]

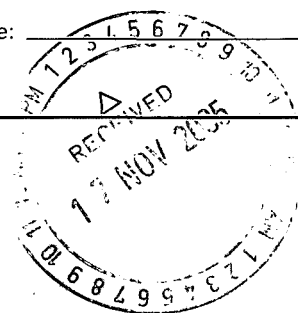

THE OWNER

Name of owner:

[include preferred form of address, eg,
Mr, Miss, Dr, if an individual]

Robert Henry Lawler

Contact person:

[insert contact name]

Mailing address:

[insert mailing address]

75a Pohutukawa Drive
Owhata, Rotorua.

Street address/registered office:

[insert street address/registered office]

Phone numbers: _____

Landline: _____ Daytime: _____

Mobile: _____ After Hours: _____

Facsimile number: _____

Email address: _____

Website: _____

[website address if applicable]

The following evidence of ownership is attached to this application:

[current copy of certificate of title, lease, agreement for sale and purchase, or other
document showing full name of legal owner(s) of the building]

AGENT

Name of agent:

[include preferred form of address, eg,
Mr, Miss, Dr, if an individual]

Nature's Flame

Contact person:

[insert contact name]

Kathryn Cunningham

Mailing address:

[insert mailing address]

P.O. Box 11-259
Christchurch

Street address/registered office:

[insert street address/registered office]

Phone numbers: _____

Landline: 0800735538 Daytime: _____

Mobile: _____ After Hours: _____

Facsimile number: 033479916

Email address: _____

Website: _____

[website address if applicable]

Relationship to owner: Agent

[state details of the authorisation from the owner to make the application on the
owner's behalf]

First point of contact for
communications with the council/
building consent authority:

[all invoices and refunds related to
this application will be directed to this
person in all instances]

Agent

THE PROJECT

Description of the building work:
[provide sufficient description of building
work to enable scope of work to be fully
understood]

Installation of Nature's Flame
wood pellet fire

Will the building work result in a
change of use of the building?

Yes ☐ No ☒

If Yes, provide details of the new use: _____

[provide description of new use]

List building consents previously issued for this project (if any):

[list who issued the consent, the date of issue and the consent number]

Intended life of the
building if less than 50 years:

50+ years

Estimated value of the building work on which the building levy will be calculated (including goods and services tax): \$ 4,409
[state estimated value as defined in section 7 of the Building Act 2004]

Number of Toilet Pans: _____
(Commercial properties only)

APPLICATION

I request that you issue a [†][project information memorandum/project information memorandum and building consent/building consent] [delete which is not applicable] for the building work described in this application

Signature of [owner/agent on behalf of and with the authority of the owner]

K. Leung

Date:

15-11-05

BUILDING PRACTITIONERS

Builder:

Business/name: _____ Address: _____

Phone: _____ Mobile: _____ After hours: _____

Facsimile: _____ Registration/qualification: _____

Designer/Architect:

Business/name: _____ Address: _____

Phone: _____ Mobile: _____ After hours: _____

Facsimile: _____ Registration/qualification: _____

Plumber:

Business/name: _____ Address: _____

Phone: _____ Mobile: _____ After hours: _____

Facsimile: _____ Registration/qualification: _____

Drainlayer:

Business/name: _____ Address: _____

Phone: _____ Mobile: _____ After hours: _____

Facsimile: _____ Registration/qualification: _____

Structural Engineer:

Business/name: _____ Address: _____

Phone: _____ Mobile: _____ After hours: _____

Facsimile: _____ Registration/qualification: _____

Engineer (identify practice college):

Business/name: _____ Address: _____

Phone: _____ Mobile: _____ After hours: _____

Facsimile: _____ Registration/qualification: _____

Head Contractor/Site Manager

Business/name: _____ Address: _____

Phone: _____ Mobile: _____ After hours: _____

Facsimile: _____ Registration/qualification: _____

Other:

Business/name: _____ Address: _____

Phone: _____ Mobile: _____ After hours: _____

Facsimile: _____ Registration/qualification: _____

COMPLIANCE

The specified systems for the building are as follows: *[specified systems are defined in regulations]*

The following specified systems are being altered, added to, or removed in the course of the building work: *[specify]*

There are no specified systems in the building. ☐

PROJECT INFORMATION MEMORANDUM

The following matters are involved in the project

- ☐ Subdivision
- ☐ Alterations to land contours
- ☐ New or altered connections to public utilities
- ☐ New or altered access for vehicles
- ☐ Disposal of stormwater and wastewater
- ☐ New or altered locations and/or external dimensions of buildings
- ☐ Building work over or adjacent to any road or public place
- ☐ Building work over any existing drains or sewers or in close proximity to wells or water mains
- ☐ Other matters known to the applicant that may require authorisations from the territorial authority: *[specify]*

BUILDING CONSENT

The following plans and specifications are attached to this application:

plans enclosed

ATTACHMENTS

The following documents are attached to this application:

- ☐ Certificate attached to project information memorandum
- ☐ Plans and specifications *[list]*
- ☐ Project information memorandum
- ☐ Development contribution notice

MATERIALS USED (identify materials used. Required for Department of Building and Housing records)

What materials will be used for the:

Floor

1 ☐ Timber 2 ☐ Concrete 3 ☐ Wood Products

4 ☐ Other Specify: _____

Framing

1 ☐ Timber 2 ☐ Concrete 3 ☐ Steel 4 ☐ Aluminium

5 ☐ Other Specify: _____

Roof

1 ☐ Steel sheeting 2 ☐ Steel tiles 3 ☐ Concrete tiles 4 ☐ Shingles

5 ☐ Aluminium 6 ☐ Other Specify: _____

Internal

1 ☐ Plaster board 2 ☐ Fibrous Plaster 3 ☐ Wood Products

4 ☐ Other Specify: _____

External Cladding

1 ☐ Brick 2 ☐ Concrete 3 ☐ Concrete block 4 ☐ Cement board

5 ☐ Plaster 6 ☐ Timber 7 ☐ Steel 8 ☐ Aluminium

9 ☐ XPS 10 ☐ Other Specify: _____

Energy

Energy source _____

Cooking: _____

Insulation _____

Connection to or disconnection from:

☐ Council water supply (Please attach "Application for Water Connection" form.) ☐ Council sewerage

ESTIMATED TOTAL VALUE OF WORK

\$ 0 gst inclusiveProject floor area _____ m²

FEE PAYABLE

Consent deposit

Project Information Memorandum \$ _____

Building Administration ✓ \$ 155.00

Technical Processing \$ _____

Industry Levy (DBH) \$ _____

Industry Levy (BRANZ) \$ _____

Developmental Contribution Levy \$ _____

Certificate of Title ✓ \$ 10.00

Producer Statements \$ _____

Compliance Schedules \$ _____

Rural Number \$ _____

Vehicle Crossing \$ _____

Street Damage \$ _____

Water Connection \$ _____

Sewer Connection \$ _____

Other(s) \$ _____

Total consent deposit \$ _____

Consent fee balance

Inspections \$ _____

Other(s) \$ _____

Total balance payable \$ 165.50

COUNCIL USE ONLY

Lodgement deposit \$ 1

Date paid _____

Receipt No. R31610Consent fee balance \$ 165.50Date paid 17-11-05

Receipt No. _____

Please complete

Forward any refunds or further invoices to:

[illegible]

HAVE YOU PROVIDED ALL THE FOLLOWING INFORMATION?

(Strike out where not applicable)

NOTE TO APPLICANTS Please use this check sheet to ensure all the information required to be supplied with your application has been provided. If required information has not been provided your application may not be accepted and you will experience delays in obtaining your consent.

GENERAL	Yes	No	BCA
Plans and specifications of an acceptable standard (Reference BRANZ Bulletin 365 Acceptable Plans and Specifications)	<input type="checkbox"/>	<input type="checkbox"/>	<input type="checkbox"/>
Plans, elevations, cross sections of the proposal in duplicate	<input type="checkbox"/>	<input type="checkbox"/>	<input type="checkbox"/>
Certificate of Title (recent search copy less than 6 months old)	<input checked="" type="checkbox"/>	<input type="checkbox"/>	<input type="checkbox"/>
Wind Zone classification	<input type="checkbox"/>	<input type="checkbox"/>	<input type="checkbox"/>
Earthquake Zone classification	<input type="checkbox"/>	<input type="checkbox"/>	<input type="checkbox"/>
Corrosion Zone classification	<input type="checkbox"/>	<input type="checkbox"/>	<input type="checkbox"/>
Presence of natural hazards eg. Flooding, falling debris, erosion	<input type="checkbox"/>	<input type="checkbox"/>	<input type="checkbox"/>

BULK & LOCATION	Yes	No	N/A
Site Plan: Fully dimensioned, scaled, showing all buildings and easements (proposed/existing)	<input type="checkbox"/>	<input type="checkbox"/>	<input type="checkbox"/>
Site boundaries nominated	<input type="checkbox"/>	<input type="checkbox"/>	<input type="checkbox"/>
Site area per unit indicated	<input type="checkbox"/>	<input type="checkbox"/>	<input type="checkbox"/>
Site coverage and plot ration calculations %	<input type="checkbox"/>	<input type="checkbox"/>	<input type="checkbox"/>
Shared access ways/other areas	<input type="checkbox"/>	<input type="checkbox"/>	<input type="checkbox"/>
Foulwater (sewer) drains	<input type="checkbox"/>	<input type="checkbox"/>	<input type="checkbox"/>
Stormwater drains and soakholes	<input type="checkbox"/>	<input type="checkbox"/>	<input type="checkbox"/>
Water service details	<input type="checkbox"/>	<input type="checkbox"/>	<input type="checkbox"/>
Site levels and finished floor level indicated	<input type="checkbox"/>	<input type="checkbox"/>	<input type="checkbox"/>
Vehicle crossing position indicated on plan	<input type="checkbox"/>	<input type="checkbox"/>	<input type="checkbox"/>
Vehicle access manoeuvre and parking areas indicated	<input type="checkbox"/>	<input type="checkbox"/>	<input type="checkbox"/>
Street trees, poles, sumps, manholes, traffic islands affecting vehicle access	<input type="checkbox"/>	<input type="checkbox"/>	<input type="checkbox"/>
Hill sites: indicate contours, drive gradients and building heights	<input type="checkbox"/>	<input type="checkbox"/>	<input type="checkbox"/>
Landscaped areas indicated and planting plan produced	<input type="checkbox"/>	<input type="checkbox"/>	<input type="checkbox"/>
Earthworks: identify proposal for cut and/or fill where cut is more than 1.5m deep or 20 cubic metres.	<input type="checkbox"/>	<input type="checkbox"/>	<input type="checkbox"/>

OTHER MISCELLANEOUS	Yes	No	N/A
Demolition details	<input type="checkbox"/>	<input type="checkbox"/>	<input type="checkbox"/>
Swimming pool: design, fence and discharge	<input type="checkbox"/>	<input type="checkbox"/>	<input type="checkbox"/>
Backflow prevention	<input type="checkbox"/>	<input type="checkbox"/>	<input type="checkbox"/>
Notable and protected trees indicated	<input type="checkbox"/>	<input type="checkbox"/>	<input type="checkbox"/>
Heritage site or building affected	<input type="checkbox"/>	<input type="checkbox"/>	<input type="checkbox"/>
Resource Consent application	<input type="checkbox"/>	<input type="checkbox"/>	<input type="checkbox"/>
Subdivision details	<input type="checkbox"/>	<input type="checkbox"/>	<input type="checkbox"/>

CONSTRUCTION DETAILS	Yes	No	BCA
Products and designs match selected earthquake, wind and corrosion zones	<input type="checkbox"/>	<input type="checkbox"/>	<input type="checkbox"/>
Timber treatment specifications	<input type="checkbox"/>	<input type="checkbox"/>	<input type="checkbox"/>
Foundation plans and design included. Plans to show details on reinforcing, all fixings and subfloor bracing for timber floors.	<input type="checkbox"/>	<input type="checkbox"/>	<input type="checkbox"/>
Floor slab details including location of expansion joints	<input type="checkbox"/>	<input type="checkbox"/>	<input type="checkbox"/>
Geotechnical reports on ground condition as required	<input type="checkbox"/>	<input type="checkbox"/>	<input type="checkbox"/>
Floor plans with fire partitions, common walls & dividing walls & identification of all rooms & their intended uses	<input type="checkbox"/>	<input type="checkbox"/>	<input type="checkbox"/>
Elevations with maximum height and daylighting recession planes	<input type="checkbox"/>	<input type="checkbox"/>	<input type="checkbox"/>
Beam designs including fixings, design charts for manufactured beams where used	<input type="checkbox"/>	<input type="checkbox"/>	<input type="checkbox"/>
Roof plan complete with truss design statement and details	<input type="checkbox"/>	<input type="checkbox"/>	<input type="checkbox"/>
Details to resist roof uplift	<input type="checkbox"/>	<input type="checkbox"/>	<input type="checkbox"/>
Bracing calculations and layout plans	<input type="checkbox"/>	<input type="checkbox"/>	<input type="checkbox"/>
Brace fixing details	<input type="checkbox"/>	<input type="checkbox"/>	<input type="checkbox"/>
Blockwork design, including cover to reinforcing, locations and detail of expansion joints, fixings.	<input type="checkbox"/>	<input type="checkbox"/>	<input type="checkbox"/>
Retaining walls: design, heights, position, subsoil drainage and safety barriers	<input type="checkbox"/>	<input type="checkbox"/>	<input type="checkbox"/>
Windows: opening and fixed windows indicated, cantilevered lintel details included where appropriate	<input type="checkbox"/>	<input type="checkbox"/>	<input type="checkbox"/>
Glazing: safety glass specifications included	<input type="checkbox"/>	<input type="checkbox"/>	<input type="checkbox"/>
Sound insulation indicated	<input type="checkbox"/>	<input type="checkbox"/>	<input type="checkbox"/>
Location of smoke detectors	<input checked="" type="checkbox"/>	<input type="checkbox"/>	<input type="checkbox"/>
Claddings and weathertightness details provided for all claddings, including risk matrix or equivalent	<input type="checkbox"/>	<input type="checkbox"/>	<input type="checkbox"/>
Stairs/steps/landings/balconies: dimensions, handrail and barrier details	<input type="checkbox"/>	<input type="checkbox"/>	<input type="checkbox"/>
Decks: membrane specifications (especially compatible substrates), threshold details, position and size of overflows, gutter size calculations,	<input type="checkbox"/>	<input type="checkbox"/>	<input type="checkbox"/>
Solid fuel heater: make, model & location	<input checked="" type="checkbox"/>	<input type="checkbox"/>	<input type="checkbox"/>
Accurate layout of plumbing & drainage systems	<input type="checkbox"/>	<input type="checkbox"/>	<input type="checkbox"/>
Producer Statement: specific design details for work outside the scope of acceptable solutions and non specific design codes.	<input type="checkbox"/>	<input type="checkbox"/>	<input type="checkbox"/>
Fire Safety Summary or Fire Design statement	<input type="checkbox"/>	<input type="checkbox"/>	<input type="checkbox"/>
Drainage and/or plumbing	<input type="checkbox"/>	<input type="checkbox"/>	<input type="checkbox"/>
Lifts, escalators, moving walkways	<input type="checkbox"/>	<input type="checkbox"/>	<input type="checkbox"/>
Acoustic and thermal insulation	<input type="checkbox"/>	<input type="checkbox"/>	<input type="checkbox"/>
HVAC systems	<input type="checkbox"/>	<input type="checkbox"/>	<input type="checkbox"/>
Energy	<input type="checkbox"/>	<input type="checkbox"/>	<input type="checkbox"/>
People with disabilities access & facilities	<input type="checkbox"/>		
Independent peer review for specialist design above			
Compliance Schedule details			

The building work will comply with the building code as follows: *[Delete this section if this is an application for a PIM only]*

Clause <i>[which of the following clauses will be involved in the proposed building work?]</i>	Means of compliance <i>[refer to the relevant compliance document(s) or detail of alternative solution in the plans and specifications]</i>	Proposed inspections <i>[state means of inspection. Note PS4 or certification may be required]</i>
<input checked="" type="checkbox"/> B1 Structure	<input checked="" type="checkbox"/> B1/AS2 <input type="checkbox"/> NZS 3604 <input type="checkbox"/> NZS 4203 <input type="checkbox"/> NZS 4229 <input type="checkbox"/> Other _____ <i>[Specify]</i>	<input type="checkbox"/> Council <input type="checkbox"/> Engineer <input type="checkbox"/> Other _____ <i>[Specify]</i>
<input checked="" type="checkbox"/> B2 Durability	<input checked="" type="checkbox"/> B2/AS1 <input type="checkbox"/> NZS 3101 <input type="checkbox"/> NZS 3602 <input type="checkbox"/> NZS 3604 <input type="checkbox"/> Other _____ <i>[Specify]</i>	<input type="checkbox"/> Council <input type="checkbox"/> Engineer <input type="checkbox"/> Other _____ <i>[Specify]</i>
<input checked="" type="checkbox"/> C1- 4 Fire	<input checked="" type="checkbox"/> C1/AS1 <input type="checkbox"/> Other _____ <i>[Specify]</i>	<input type="checkbox"/> Council <input type="checkbox"/> Engineer <input type="checkbox"/> Other _____ <i>[Specify]</i>
<input type="checkbox"/> D1 Access Routes	<input type="checkbox"/> D1/AS1 <input type="checkbox"/> ZS 4121 <input type="checkbox"/> NZS 4121 <input type="checkbox"/> Other _____ <i>[Specify]</i>	<input type="checkbox"/> Council <input type="checkbox"/> Engineer <input type="checkbox"/> Other _____ <i>[Specify]</i>
<input type="checkbox"/> D1 Mechanical installations for access	<input type="checkbox"/> D2/AS1 <input type="checkbox"/> NZS 4332 <input type="checkbox"/> EN 81 <input type="checkbox"/> EN 115 <input type="checkbox"/> Other _____ <i>[Specify]</i>	<input type="checkbox"/> Engineer <input type="checkbox"/> Other _____ <i>[Specify]</i>
<input type="checkbox"/> E1 Surface water	<input type="checkbox"/> E2/AS1 <input type="checkbox"/> AS/NZS3500.3 <input type="checkbox"/> Other _____ <i>[Specify]</i>	<input type="checkbox"/> Council <input type="checkbox"/> Other _____ <i>[Specify]</i>
<input checked="" type="checkbox"/> E2 External moisture	<input checked="" type="checkbox"/> E2/AS1 <input type="checkbox"/> Specific design & testing	<input type="checkbox"/> Council <input type="checkbox"/> Other _____ <i>[Specify]</i>
<input type="checkbox"/> E3 Internal moisture	<input type="checkbox"/> E2/AS1 <input type="checkbox"/> Other _____ <i>[Specify]</i>	<input type="checkbox"/> Council <input type="checkbox"/> Other _____ <i>[Specify]</i>
<input type="checkbox"/> F1 Hazardous substances etc	<input type="checkbox"/> F1/AS1 <input type="checkbox"/> Other _____ <i>[Specify]</i>	<input type="checkbox"/> Council <input type="checkbox"/> Other _____ <i>[Specify]</i>
<input type="checkbox"/> F2 Hazardous building materials	<input type="checkbox"/> F2/AS1 <input type="checkbox"/> NZS 4223 <input type="checkbox"/> Other _____ <i>[Specify]</i>	<input type="checkbox"/> Council <input type="checkbox"/> Other _____ <i>[Specify]</i>
<input type="checkbox"/> F3 Hazardous substances	<input type="checkbox"/> F3/AS1 <input type="checkbox"/> Other _____ <i>[Specify]</i>	<input type="checkbox"/> Council <input type="checkbox"/> Other _____ <i>[Specify]</i>
<input type="checkbox"/> F4 Safety from falling	<input type="checkbox"/> F2/AS1 <input type="checkbox"/> FSP Act <input type="checkbox"/> Other _____ <i>[Specify]</i>	<input type="checkbox"/> Council <input type="checkbox"/> Other _____ <i>[Specify]</i>
<input type="checkbox"/> F5 Construction and demolition hazards	<input type="checkbox"/> F5/AS1 <input type="checkbox"/> Other _____ <i>[Specify]</i>	<input type="checkbox"/> Council <input type="checkbox"/> Other _____ <i>[Specify]</i>
<input type="checkbox"/> F6 Lighting for emergency	<input type="checkbox"/> F6/AS1 <input type="checkbox"/> Other _____ <i>[Specify]</i>	<input type="checkbox"/> Council <input type="checkbox"/> Other _____ <i>[Specify]</i>
<input type="checkbox"/> F7 Warning systems	<input type="checkbox"/> F7/AS1 <input type="checkbox"/> AS/NZS 1668 <input type="checkbox"/> NZS 4512 <input type="checkbox"/> NZS 4515 <input type="checkbox"/> Other _____ <i>[Specify]</i>	<input type="checkbox"/> Council <input type="checkbox"/> Engineer <input type="checkbox"/> Other _____ <i>[Specify]</i>
<input type="checkbox"/> F8 Signs	<input type="checkbox"/> F8/AS1 <input type="checkbox"/> Other _____ <i>[Specify]</i>	<input type="checkbox"/> Council <input type="checkbox"/> Other _____ <i>[Specify]</i>
<input type="checkbox"/> G1 Personal hygiene	<input type="checkbox"/> G1/AS1 <input type="checkbox"/> Other _____ <i>[Specify]</i>	<input type="checkbox"/> Council <input type="checkbox"/> Other _____ <i>[Specify]</i>

<input type="checkbox"/> G2	Laundrying	<input type="checkbox"/> G2/AS1	<input type="checkbox"/> Other _____ [Specify]	<input type="checkbox"/> Council <input type="checkbox"/> Other _____ [Specify]
<input type="checkbox"/> G3	Food preparation and prevention of contamination	<input type="checkbox"/> G3/AS1	<input type="checkbox"/> Other _____ [Specify]	<input type="checkbox"/> Council <input type="checkbox"/> Other _____ [Specify]
<input type="checkbox"/> G4	Ventilation	<input type="checkbox"/> F7/AS1	<input type="checkbox"/> AS/NZS 1668.2 <input type="checkbox"/> Other _____ [Specify]	<input type="checkbox"/> Council <input type="checkbox"/> Other _____ [Specify]
<input type="checkbox"/> G5	Interior environment	<input type="checkbox"/> G5/AS1	<input type="checkbox"/> Other _____ [Specify]	<input type="checkbox"/> Council <input type="checkbox"/> Other _____ [Specify]
<input type="checkbox"/> G6	Airborne & impact sound	<input type="checkbox"/> G6/AS1	<input type="checkbox"/> Other _____ [Specify]	<input type="checkbox"/> Council <input type="checkbox"/> Other _____ [Specify]
<input type="checkbox"/> G7	Natural light	<input type="checkbox"/> G7/AS1	<input type="checkbox"/> Other _____ [Specify]	<input type="checkbox"/> Council <input type="checkbox"/> Other _____ [Specify]
<input type="checkbox"/> G8	Artificial light	<input type="checkbox"/> G8/AS1	<input type="checkbox"/> NZS 6703 <input type="checkbox"/> Other _____ [Specify]	<input type="checkbox"/> Council <input type="checkbox"/> Other _____ [Specify]
<input type="checkbox"/> G9	Electricity	<input type="checkbox"/> G9/AS1	<input type="checkbox"/> Other _____ [Specify]	By certification only
<input type="checkbox"/> G10	Piped services	<input type="checkbox"/> G10/AS1	<input type="checkbox"/> NZS 5261 <input type="checkbox"/> Other _____ [Specify]	By certification only
<input type="checkbox"/> G11	Gas as an energy source	<input type="checkbox"/> G11/AS1	<input type="checkbox"/> Other _____ [Specify]	By certification only
<input type="checkbox"/> G12	Water supplies	<input type="checkbox"/> G12/AS1	<input type="checkbox"/> AS/NZS 3500.1 <input type="checkbox"/> AS/NZS 3500.4 <input type="checkbox"/> Other _____ [Specify]	<input type="checkbox"/> Council <input type="checkbox"/> Other _____ [Specify]
<input type="checkbox"/> G13	Foul water	<input type="checkbox"/> G13/AS1	<input type="checkbox"/> AS/NZS 3500.2 BS 5572 <input type="checkbox"/> Other _____ [Specify]	<input type="checkbox"/> Council <input type="checkbox"/> Other _____ [Specify]
<input type="checkbox"/> G14	Industrial liquid waste	<input type="checkbox"/> G14/AS1	<input type="checkbox"/> Other _____ [Specify]	<input type="checkbox"/> Council <input type="checkbox"/> Other _____ [Specify]
<input type="checkbox"/> G15	Solid waste	<input type="checkbox"/> G15/AS1	<input type="checkbox"/> Other _____ [Specify]	<input type="checkbox"/> Council <input type="checkbox"/> Other _____ [Specify]
<input type="checkbox"/> H1	Energy efficiency	<input type="checkbox"/> H1/AS1	<input type="checkbox"/> NZS 4218 <input type="checkbox"/> NZS 4243 <input type="checkbox"/> ALF Design Manual <input type="checkbox"/> NZS 4214 <input type="checkbox"/> Other _____ [Specify]	<input type="checkbox"/> Council <input type="checkbox"/> Other _____ [Specify]

WAIVER/MODIFICATION TO NZ BUILDING CODE REQUIRED FOR FOLLOWING PARTS OF CODE:



201a, c, d, e

218C

218e

220b.

Rotorua District Council
1061 Haupapa Street
Private Bag 3029
Rotorua, New Zealand
P: 07 348 4199
F: 07 346 3143
E: mail@rdc.govt.nz
W: www.rdc.govt.nz

Code Compliance Certificate: 32241
Section 95, Building Act 2004

Issued: 17 Jan 06

The Building

Street Address of building: 75A POHUTUKAWA DRIVE, OWHATA, ROTORUA 3201
Legal Description of land where building is located:

FLAT 1 DPS 44084 - P 25490

Current, lawfully established use:

Year first constructed:

- INSTALL NATURES FLAME WOOD PELLET FIRE

The Owner

Name of owner: MR ROBERT HENRY LAWLER
Contact Person: SOLID ENERGY RENEWABLE FUELS
Mailing Address: ATTN: KATHRYN CUNNINGHAM
C/O NATURES FLAME
BOX 11259, CHRISTCHURCH

Street address/registered office: 75A POHUTUKAWA DRIVE
OWHATA
ROTORUA 3201 ✓
Phone number: 021 848791 (Bus.)
3454019 (Pvt.)

Facsimile number:
Email address:
Website:

First point of contact for communications with council/building consent authority:

Building Work

Building Consent number: 32241
Issued by: ROTORUA DISTRICT COUNCIL

Code Compliance

The building consent authority named below is satisfied, on reasonable grounds, that -

No fees

(a) the building work complies with the building consent.

Council Charges

The Council's total charges payable on the uplifting of this code compliance certificate in accordance with the attached details are: \$0.00

This is a final code compliance certificate issued in respect of all of the building work under the above building consent

D. MACLEOD

BUILDING ADMINISTRATION

On behalf of: ROTORUA DISTRICT COUNCIL

Date: 17 Jan 2006

Rotorua District Council
1061 Haupapa Street
Private Bag 3029
Rotorua, New Zealand
P: 07 348 4199
F: 07 346 3143
E: mail@rdc.govt.nz
W: www.rdc.govt.nz

FIELD INSPECTION CARD

Date Consent Issued:

DESCRIPTION OF PROPOSED WORK: Install Natures Flame Wood Pellet Fire.

Document Set ID: 616498
Version: 1, Version Date: 02/06/2010

[illegible]

SOLID FUEL HEATERS				
CONSENT No	OK	NO	NA	COMMENTS
OWNER				
ADDRESS				
P No				
INSTALLER				
IN BUILT 1st INSPECTION				
Correct house/ street no identified				
Building Consent documentation is on site				
Read conditions of Building Consent				
Brick cavity is sound and has been correctly sealed/ repaired				
Hearth is correct dimensions/ front to back				
Hearth is correct dimensions/ each side of fire				
Hearth is constructed of correct material				
Mantel has sufficient clearance				
Discuss smoke alarms				
IN BUILT 2nd INSPECTION				
Building Consent documentation is on site				
Read conditions of Building Consent				
Hearth is correct dimensions/ front to back				
Hearth is correct dimensions/ each side of fire				
Hearth is constructed of correct material				
Mantel has sufficient clearance				
Deflector is fitted to mantel				
Heater is bolted down				
Smoke alarms within 3m of all bed rooms				
Flashings to roof comply				
Application for CCC received				
FREE STANDING SOLID FUEL HEATER				
Correct house/ street no identified	✓			
Building Consent documentation is on site	✓			
Read conditions of Building Consent	✓			
Flue shield fitted?		✓		
Rear clearance is correct between wall & SFH	✓			
Side clearance is correct between wall & SFH	✓			
Hearth size to sides is correct	✓			
Hearth dimension in front of SFH is correct	✓			
Heater is bolted down	✓			
Flue is pop riveted together	✓			
Ceiling plate is on ceramic spacers	✓			
Outer flue is fixed to supporting nogs	✓			
25mm Air gap around outer flue or square hole in ceiling	✓			
Roof space framing is intact/ not cut away	✓			
Smoke alarms fitted within 3m of bedrooms	✓			
Record plumbers details if wet back fitted			✓	
Wet back pipe is copper			✓	
Wet back pipe is run correctly			✓	
Tempering valve is fitted?			✓	
Water temperature is correct			✓	
Vent is to open air off HWC			✓	
Flashing to roof complies?	✓			
Application for CCC received		✓		

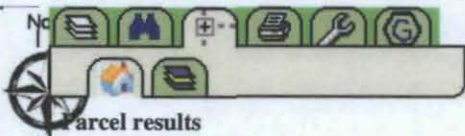

Parcel results

- Rating Parcel - File: 25490 (75A Pohutukawa Dri
- 75A Pohutukawa Drive, Owkata, Rotorua,
- Header_Id:20280
- [Display rating parcel...](#)
- Rating details for 06993/163.01A ...
- [Generate parcel map...](#)
- [Text note details...](#)
- Ownership details...
- ROBERT HENRY LAWLER
- 75A Pohutukawa Drive, Owkata, Rot
- [Open occupancies on this parcel in a new wir](#)
- [Legal Parcel - File: \(Lot 121 DPS 42471\)](#)
- [Cross Lease Parcel - File: 25490 \(FLAT 1 DP](#)
- [Cross-lease Parcel - File: 25490 \(FLAT 1 DPS 440](#)

☐ Recenter

☐ Id DataLayers

☐ Zoom In

☒ Id Legal Parcel

☐ Zoom Out

☐ Measure

Scale: 1:707

Map Type: Default





**COMPOSITE COMPUTER REGISTER
UNDER LAND TRANSFER ACT 1952**



R. W. Muir
Registrar-General
of Land

Search Copy

Identifier SA38A/624
Land Registration District South Auckland
Date Issued 19 March 1987

Prior References
SA37C/741

Estate Fee Simple - 1/2 share
Area 864 square metres more or less
Legal Description Lot 121 Deposited Plan South Auckland
42471

Proprietors
Robert Henry Lawler

Estate	Leasehold	Instrument	L H715445.1
		Term	999 years as from and including 25.2.1987

Legal Description Flat 1 Deposited Plan South Auckland
44084

Proprietors
Robert Henry Lawler

Interests

H715445.1 Lease of Flat 1 DPS 44084 Term 999 years as from and including 25.2.1987 Composite CT SA38A/624 issued - 19.3.1987 (Affects Fee Simple)

Land Covenant in Lease H715445.1 - 19.3.1987 (Affects Fee Simple)

H715445.2 Lease of Flat 2 Term 999 years as from and including 25.2.1987 Composite CT SA38A/625 issued - 19.3.1987 (Affects Fee Simple)

Land Covenant in Lease H715445.2 - 19.3.1987 (Affects Fee Simple)

6501950.3 Mortgage to ANZ National Bank Limited - 20.7.2005 at 9:00 am

17/12/1986

Lot 254 has no frontage to a Public Road

Lots	C.T.s
121	37C, 74J
254	LP Res. (Pumping Stn. Site) to Vest

PT. OWHATA 3C
S048726
Soil Conservation & River Control
Dist. 1979 p. 1815

246
DPS 39981

3C
ML12942

121
864 m²

120
DPS 39981

121
DPS 39981

254
22 m²
TO VEST AS LOCAL PURPOSE RESERVE (PUMPING STATION SITE)

122
DPS 39981

POHUTUKAWA DRIVE
PUBLIC ROAD
VESTED DPS 39981

17/12/1986

APPROVED THE COMMON SEAL OF UNITED PLANNERS AND SOCIETIES LIMITED WHOSE MEMBERS HAVE BEEN ADVISED IN THE PRESENCE OF

APPROVED TO A REBELLION OF THE ROTORUA DISTRICT COUNCIL PASSED ON THE 11th DAY OF JULY 1986 APPROVING A RESOLUTION TO REVERT TO THE LOCAL GOVERNMENT ACT 1974 THIS EMBLEM PLAN AND CERTIFYING THAT THE PLAN IS IN ACCORDANCE WITH THE REQUIREMENTS AND PROVISIONS OF THE OPERATIVE DISTRICT SCHEME THE COMMON SEAL OF THE ROTORUA DISTRICT COUNCIL WAS AFFIXED HERETO IN THE PRESENCE OF

APPROVED TO SECTION 30(4) OF LOCAL GOVT ACT 1974 I DO HEREBY CERTIFY THAT THERE WERE NO OBJECTIONS EXHIBIT ON OR REFERRED TO ON THE SCHEME PLAN OF SUBDIVISION.

DATED AT ROTORUA THIS 12th DAY OF July 1986

DISTRICT MANAGER

Total Area 886 m²

Comprised in CT 350 - 999 (All)

I, JOHN JOHN KINK, Registered Surveyor and holder of an annual practicing certificate for 1986 and 1987 as a registered surveyor pursuant to the provisions in section 280(1) of the Survey Act 1982 hereby certify that this plan has been made from surveys executed by me or under my direction, that both plan and survey are correct and have been made in accordance with the Survey Regulations 1971.

Dated at ROTORUA this 22nd day of July 1986

Field Book
Reference Plan CT 350 - 999

Classified Official
Approved as to Survey
Deposited this 22nd day of February 1986

CHIEF SURVEYOR
DPS 42671

LAND DISTRICT SOUTH AUCKLAND
SURVEY BLK. & DIST. 11 TARAWERA (Rotorua)
MEMS 261 SHE 1416 RECORD MAP No 60:05

LOTS 121 and 254 BEING SUBDIVISION OF LOT 121 DPS39981 BEING PT. OWHATA 3C BLOCK

TERRITORIAL AUTHORITY ROTORUA DISTRICT
Surveyed by MARTIN, McCULLAY & MORTON
Scale 1:250 Date FEB. 1986

WKS. IMPDET. SURVEYOR GENERAL, DEPARTMENT OF LANDS AND SURVEY NEW ZEALAND

19/1/1986



PT OWHATA 3C
EQ 48126
Soil Cont. & River Control
H 289266

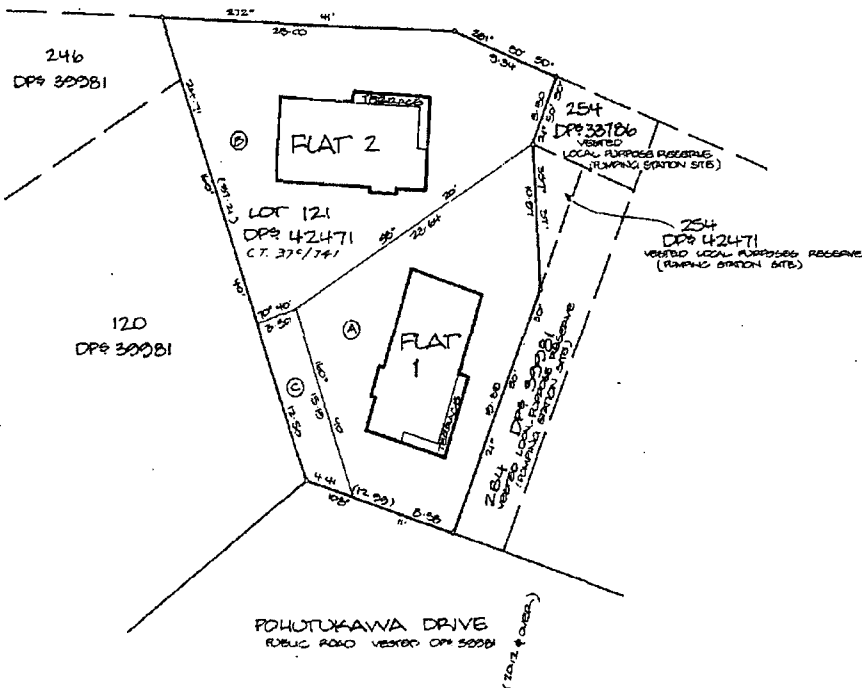

Approved: [Signature]
Only authorized Agent of the Registrar-General
Planning & Environment Unit

UNITED FINANCIAL & SECURITIES LIMITED
PURSUANT TO SECTION 224 OF THE LOCAL
GOVERNMENT ACT 1974 I HEREBY
CERTIFY THAT CONSTRUCTION OF THE
BUILDINGS DEPICTED HEREON
COMMENCED ON OR AFTER 1 JANUARY 1986
AND A BUILDING PERMIT FOR THE
CONSTRUCTION OF THE BUILDINGS
DEPICTED HAS BEEN ISSUED BY THE
ROTORUA DISTRICT COUNCIL PURSUANT
TO ITS BY-LAWS.

ENTERED THIS 13th DAY OF JULY 1986
[Signature]
DISTRICT MANAGER

DATED THE 15th DAY OF DECEMBER 1985
[Signature]
DISTRICT MANAGER

I HEREBY CERTIFY THAT THE
BUILDINGS SHOWN HEREON ARE
ERECTED IN THE PORTIONS SHOWN
AND ARE WITHIN THE BOUNDARIES
OF CT. 37°/74' LOT 121 DP# 42471

[Signature]
ANNA WILSON
REGISTERED SURVEYOR

Total Area: 8144 M²
Comprised in CT. 37°/74' (1/11)

I, ALAN WILLIAM DEK MACAULAY
Registered Surveyor and holder of an annual practicing certificate for sale
may act as a registered surveyor pursuant to the provisions of section 224
of the Surveyors Act 1980 hereby certify that this plan has been made
from surveys conducted by me or under my direction that field plans and
survey are correct and have been made in accordance with the Survey
Regulations 1972.
Dated at Rotorua this 15th day
of Dec 1985 Signed [Signature]

And that:
Reference Plans: DP# 33706, DP# 33707
Created: [Signature] Date: [Signature]
Approved for READING PURPOSES ONLY
15/1/87 UNO TO 15/1/87
Deposited this 15th day of July 1986
For Registrar: [Signature] 19/1/86
15/1/86 19/1/86
DPS 4084

LAND DISTRICT SOUTH AUCKLAND
SURVEY BLK. & DIST. 11 TARAWERA
NZRS 261 SH1 RECORD MAP No. 150.00

FLATS SITUATED ON LOT 121 DP# 42471
BEING PART
OWHATA 3C BLOCK

TERRITORIAL AUTHORITY ROTORUA DISTRICT
Surveyed by MARTIN MACAULAY MORTON
Scale 1:200 Date JUNE 1986

Nature's Flame Pellet fire

Specifications

EF2 and EF3 Pellet fires are available in free standing (EF), fireplace insert (FPI), and built-in heater (BIH) models.

EF5 and Windsor are available in free standing only.

DIMENSIONS AT BACK OF UNIT

	EF2/EF3	EF5
Width X depth	55x60cm	65x46cm
Height	76cm	85cm
A. Front of unit on hearth	325mm	n/a
B. Recess depth into fireplace	275mm	n/a
Standard Surround (H x W)	77x102cm	n/a
Oversized surround (H x W)	82.5x115cm	n/a
C. Side wall to unit	150mm	75mm
D. Back wall to unit	50mm	50mm
E. Wall to corner of unit	50mm	100mm
F. Floor protector (in front of unit)	150mm	n/a
G. Top of unit to mantle	200mm	n/a
H. Unit top to surround top	200mm	n/a
I. Unit to mantle pillar	150mm	n/a

PLANS APPROVED SUBJECT TO ALL
REQUIREMENTS OF THE BUILDING
ACT 2004 BEING FULLY COMPLIED
WITH

DATE: 6.11.05 CONSENT No: 3041
OFFICER: [Signature]

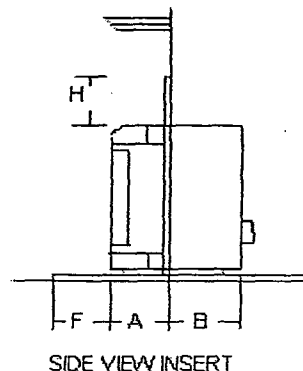
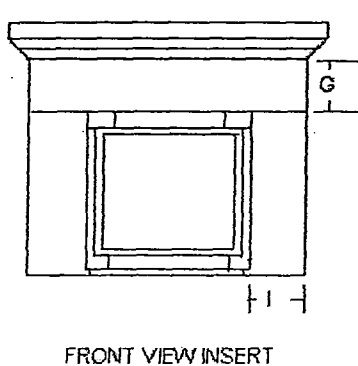
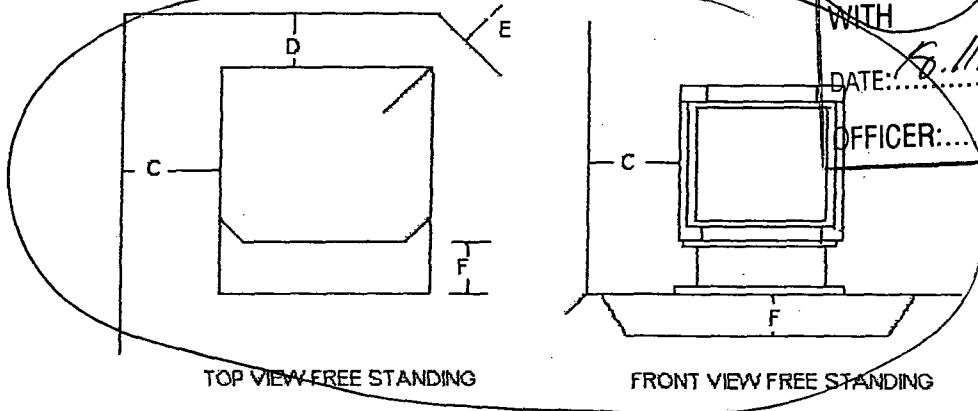

Nature's Flame
PO Box 11-259
Christchurch

Phone 03 347 9915
Fax 03 347 9916

FLOOR PLAN

Site Address

Rob Lawler
75a Pahutukawa Drive
Owhate,
Rotorua 3201.

Solid Energy Renewable Fuels Ltd
Contract No. 1710, PO Box 11-259
Christchurch, New Zealand
Tel +64 3 347 9915
Fax +64 3 347 9916
Website www.naturesflame.co.nz

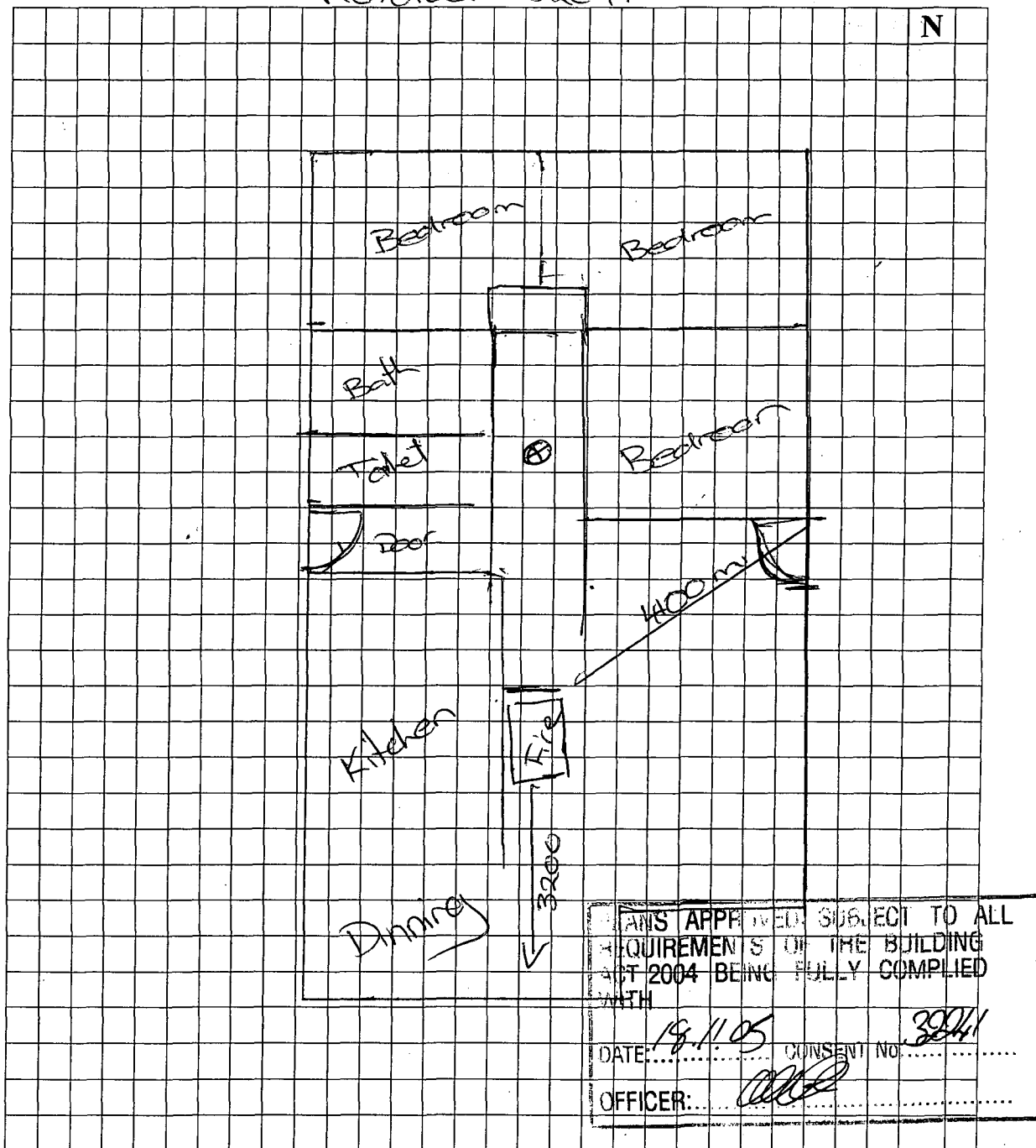

INTERNAL FLUE KIT

I HAVE APPROVED THIS KIT TO ALL
 REQUIREMENTS OF THE BUILDING
 ACT 2004 BEING FULLY COMPLIED
 WITH
 DATE: 18.11.05 CONSENT No: 32241
 OFFICER: [Signature]

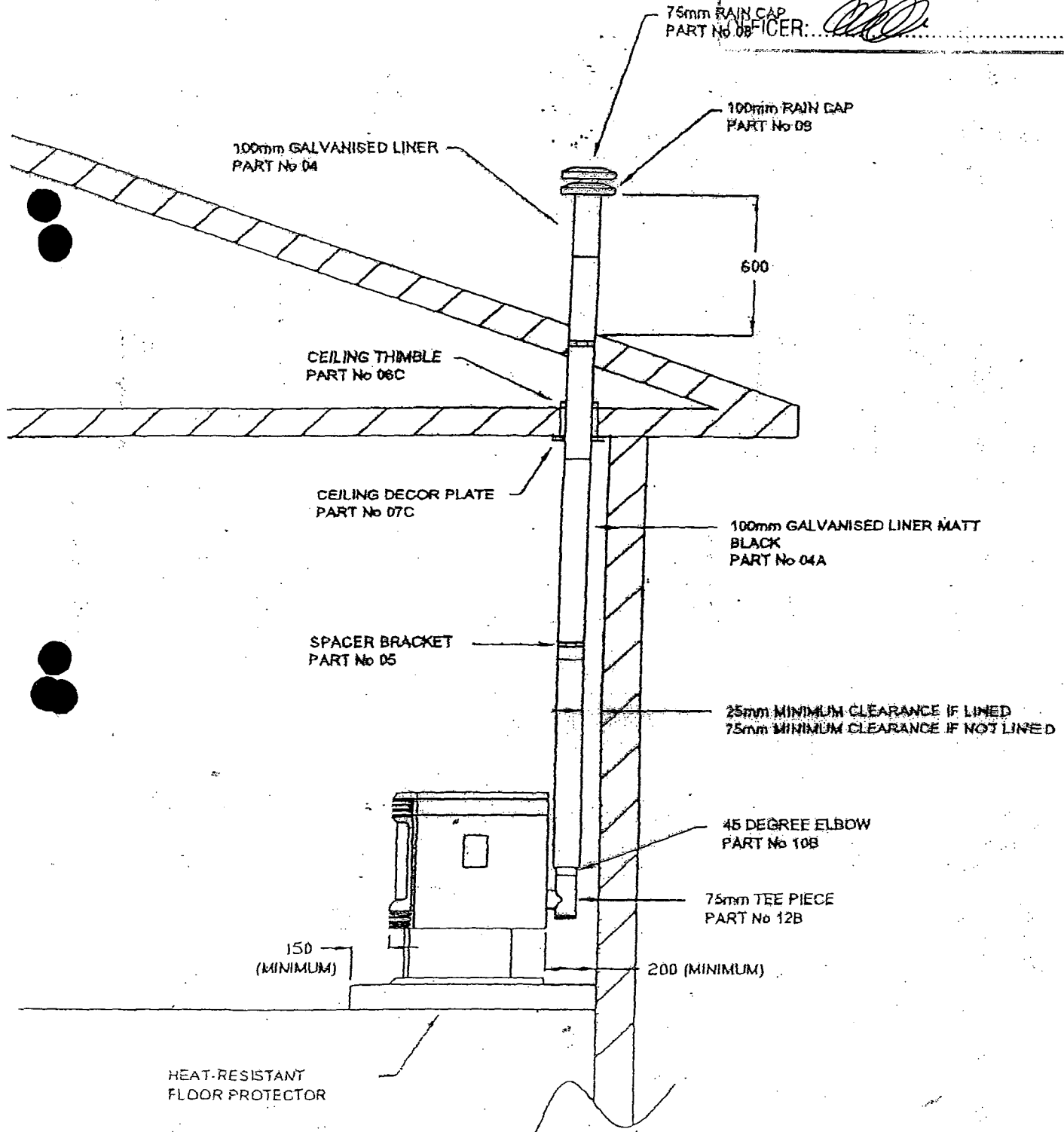

PLANS OF THE SUBJECT TO ALL
REQUIREMENTS OF THE BUILDING
ACT 2004 BEING FULLY COMPLIED
WITH

DATE: 18.11.05 CONSENT No: 32241

OFFICER: *MC*

PELLET STOVE

Nature s Flame

Installation Specifications

EVOLUTION

Free Standing Pellet Fire Place

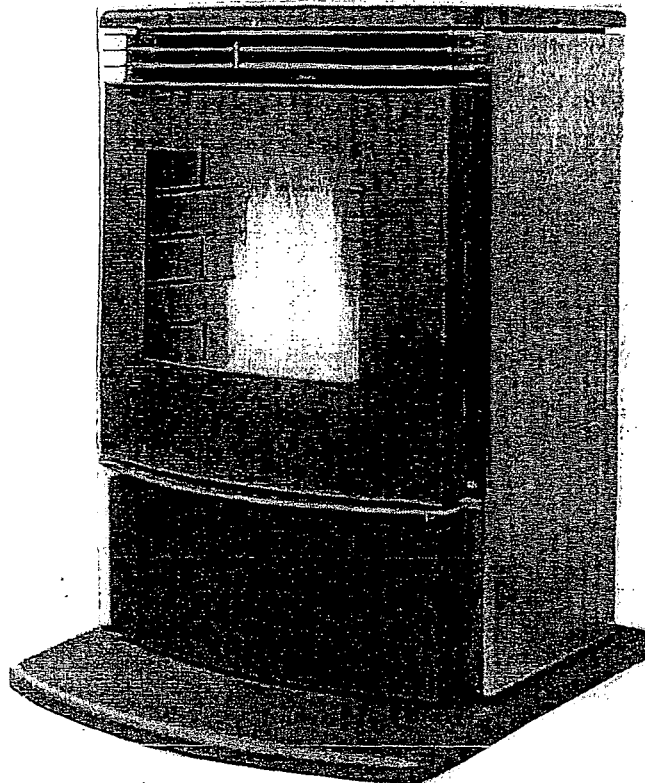

Safety Testng of the Evolution (EF5) Pellet Burning Heater to AS/NZ 02/662 and 05/1193 Emissions 02/656
Flue Kits Testing to AS/NZS 2918 AppF: 05/1185

INSTALLATION

APPLIANCE DIMENSIONS:

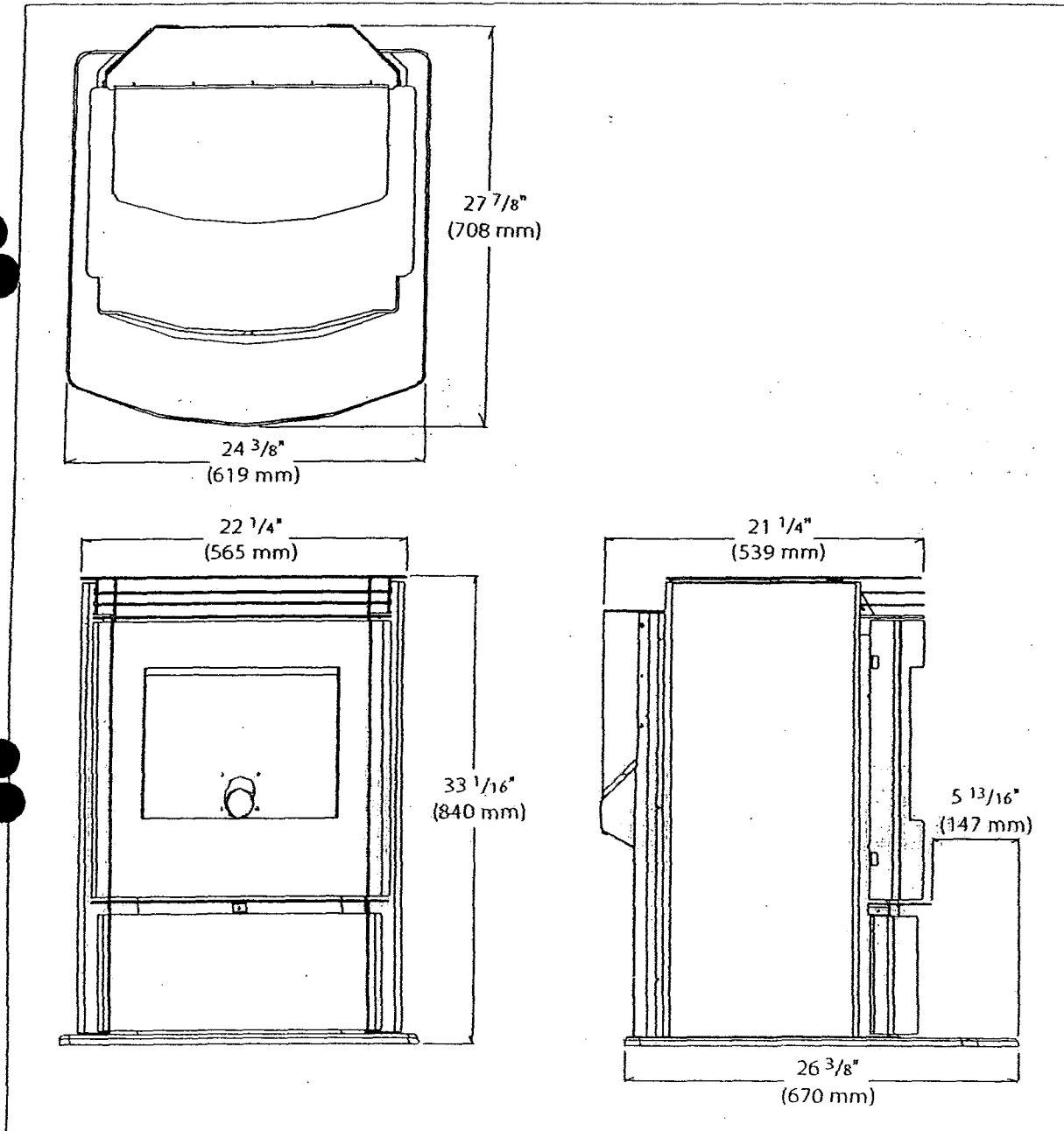

Figure 5: Dimensions of EF5.

INSTALLATION

CLEARANCES TO COMBUSTIBLES:

This unit can be installed on a combustible floor due to the built in pedestal hearth pad (for example linoleum, hardwood flooring). If this unit is to be installed onto a carpeted surface, a hearth pad must be used for stability.

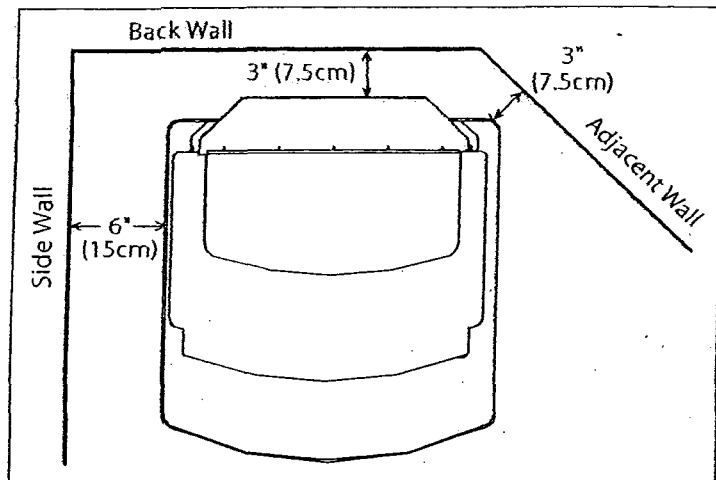

Figure 6: EF5 Clearance to Combustibles.

These dimensions are minimum clearances but it is recommended that you ensure sufficient room for serving, routine cleaning and maintenance.

Side wall to unit	6 inches	(15 cm)
Back wall to unit	3 inches	(7.5 cm)
Corner to unit	3 inches	(7.5 cm)

ALCOVE CLEARANCES:

This unit may be installed in an alcove. Maintain these clearances to combustibles.

Minimum Alcove width	48 inches	(122 cm)
Minimum Alcove height	48 inches	(122 cm)
Minimum Alcove depth	48 inches	(122 cm)

Install vent at clearances specified by the vent manufacturer.

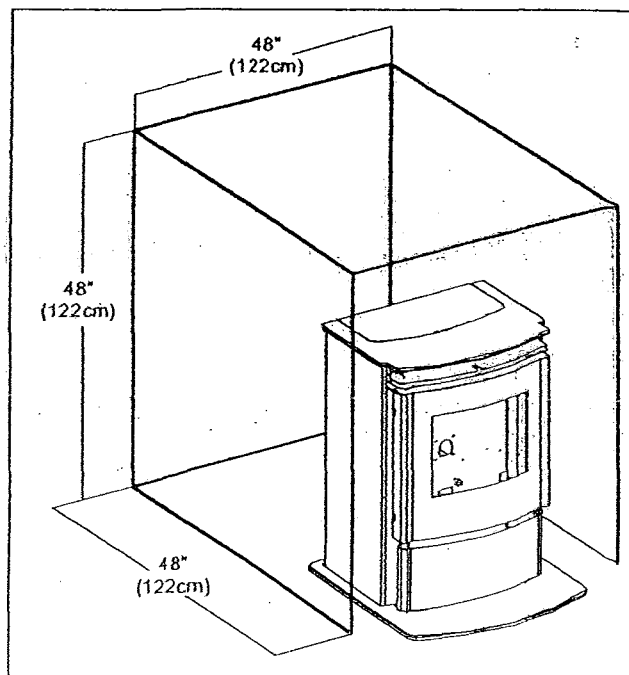

Figure 7: EF5 Minimum Alcove Size.

INSTALLATION

MOBILE HOME INSTALLATION:

- Secure the heater to the floor using the two holes in the pedestal.
- Ensure the unit is electrically grounded to the chassis of your home (permanently).
- Do not install in a room people sleep in.
- Outside fresh air is mandatory. Secure outside air connections directly to fresh air intake pipe and secure with three (3) screws evenly spaced.

CAUTION: THE STRUCTURAL INTEGRITY OF THE MANUFACTURED HOME FLOOR, WALL AND CEILING/ROOF MUST BE MAINTAINED.

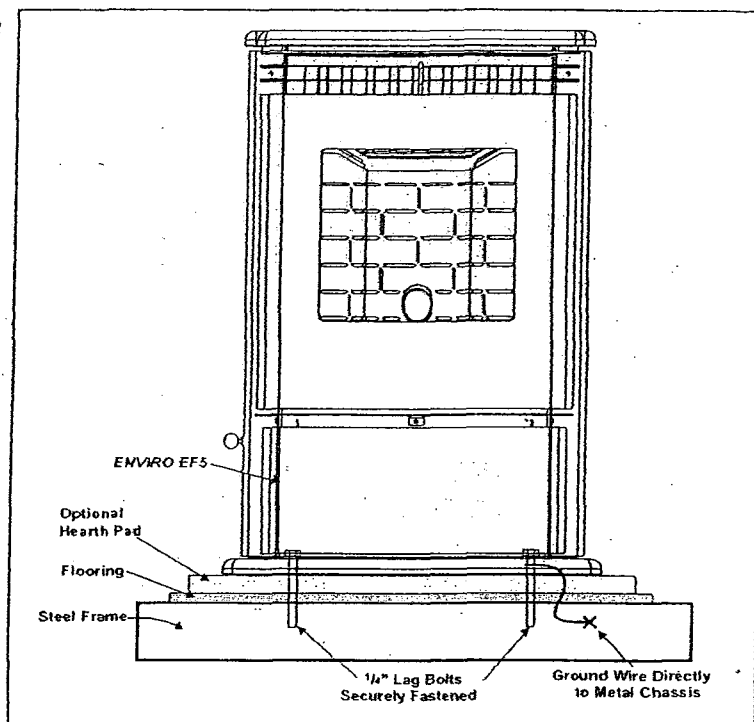

Figure 12: Mobile home installation.

CORNER THROUGH WALL INSTALLATION:

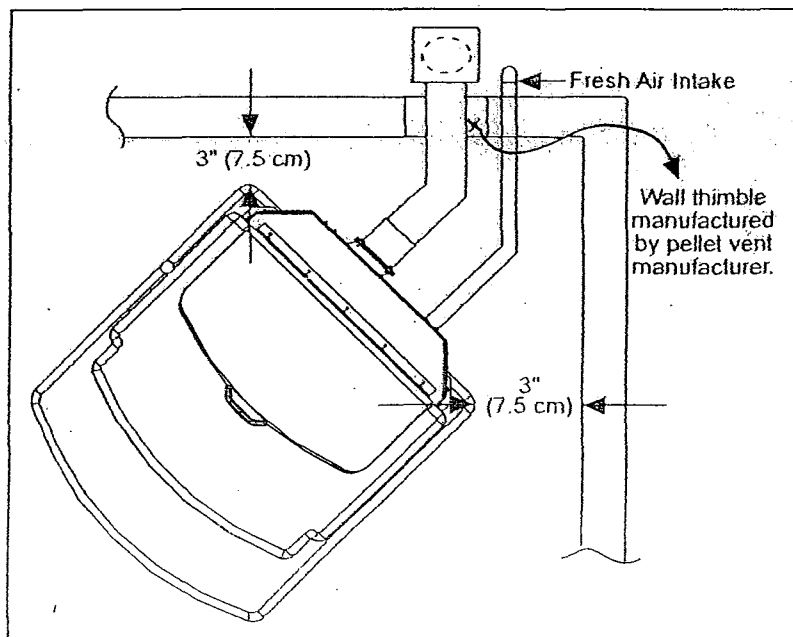

Figure 13: Corner Installation.

INSTALLATION

VENT TERMINATION REQUIREMENTS:

IT IS RECOMMENDED THAT YOUR PELLET STOVE BE INSTALLED BY AN AUTHORIZED DEALER/INSTALLER.

Table 1: Use in conjunction with Figure 9 for allowable exterior vent termination locations.

Letter	Minimum Clearance	Description
A	24 in (61 cm)	Above grass, top of plants, wood, or any other combustible materials.
B	48 in (122 cm)	From beside/below any door or window that may be opened.
C	24 in (61 cm)	From above any door or window that may be opened.
D	24 in (61 cm)	To any adjacent building, fences and protruding parts of the structure.
E	24 in (61 cm)	Below any eave or roof overhang
F	12 in (30 cm)	To outside corner.
G	12 in (30 cm)	To inside corner, combustible wall (vertical and horizontal terminations).
H	3 ft (91 cm) within a height of 15 ft (4.5 m) above the meter/regulator assembly	To each side of center line extended above natural gas or propane meter/regulator assembly or mechanical vent.
I	3 ft (91 cm)	From any forced air intake of other appliance
J	12 in (30 cm)	Clearance to non-mechanical air supply inlet to building, or the combustion air inlet to any appliance.
K	24 in (61 cm)	Clearance above roof line for vertical terminations.
L	7 ft (2.13 m)	Clearance above paved sidewalk or paved driveway located on public property.

- Do not terminate the vent in any enclosed or semi-enclosed areas such as a carport, garage, attic, crawlspace, narrow walkway, closely fenced area, under a sundeck or porch, or any location that can build up a concentration of fumes such as stairwells, covered breezeway, etc.

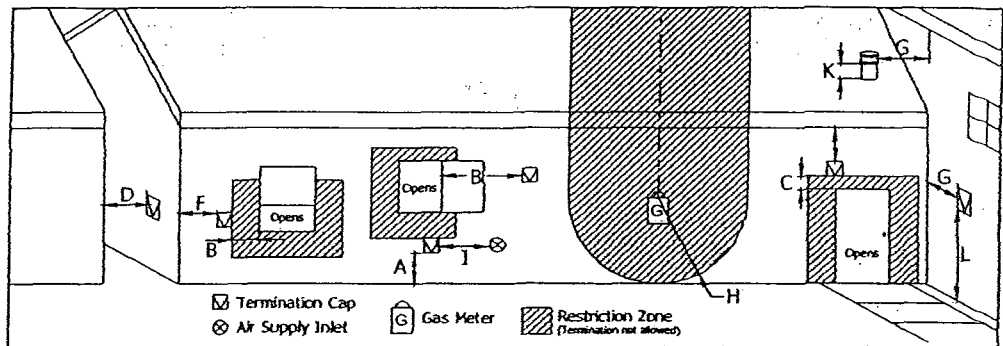

Figure 9: Use in conjunction with Table 1 for allowable exterior vent termination locations.

- Vent surfaces can become hot enough to cause burns if touched by children. Non-combustible shielding or guards may be required.
- Termination must exhaust above the inlet elevation. It is recommended that at least five feet of vertical pipe be installed outside when the appliance is vented directly through a wall, to create some natural draft to prevent the possibility of smoke or odor during appliance shut down or power failure. This will keep exhaust from causing a nuisance or hazard from exposing people or shrubs to high temperatures. In any case, the safest and preferred venting method is to extend the vent through the roof vertically.
- Distance from the bottom of the termination and grade is 12" (30 cm) minimum. This is conditional upon the plants and nature of grade surface. The exhaust gases are hot enough to ignite grass, plants and shrubs located in the vicinity of termination. The grade surface must not be lawn.
- If the unit is incorrectly vented or the air to fuel mixture is out of balance, a slight discoloration of the exterior of the house might occur. Since these factors are beyond the control of Sherwood Industries Ltd, we grant no guarantee against such incidents.

NOTE: Venting terminals shall not be recessed into walls or siding.